

ASSEMBLY INSTRUCTIONS



CAUTION

◆ Inspect the wire insulation for any cuts, abrasions, or exposed copper that may have resulted during shipping. If there is a defect in the wire, do not attempt installation.

◆ Before starting installation of this fixture or removal of a previous fixture, disconnect the power by turning off the circuit breaker or by removing the fuse at the fuse box.

TOOLS REQUIRED



Ladder



Safety glasses



Electrical tape



Phillips screwdriver



Flat blade screwdriver



Pliers

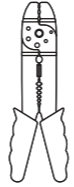

Wire strippers

HARDWARE INCLUDED

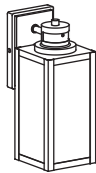

Fixture

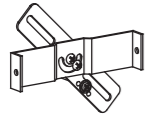

Mounting Unit



Screws



Rubber Rings



Mounting Screws



Wire Nuts

*PARTS SHOWN MAY DIFFER SLIGHTLY PER LIGHT FIXTURE

EXPLODED PARTS

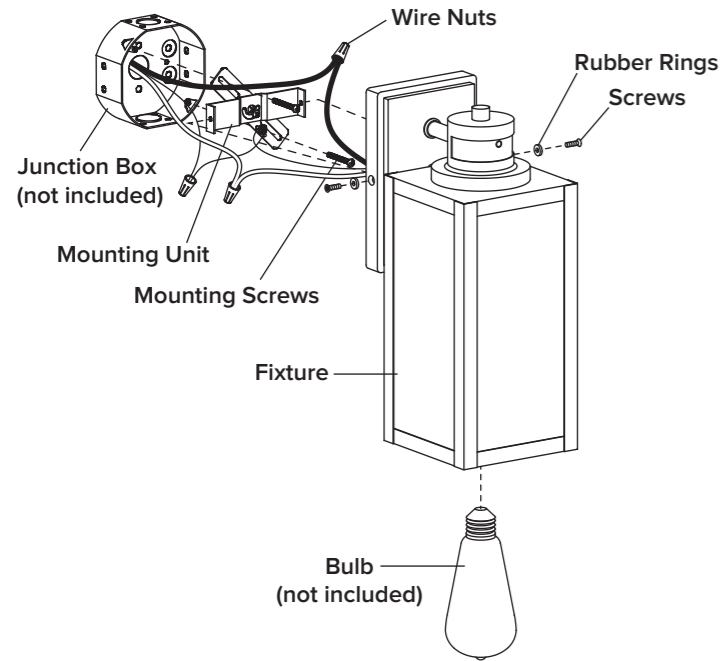

INSTALLATION

STEP 1

Unscrew the **rubber rings** and **screws** from the **mounting unit**. Use the **mounting screws** to attach the **mounting unit** to the junction box (not included).

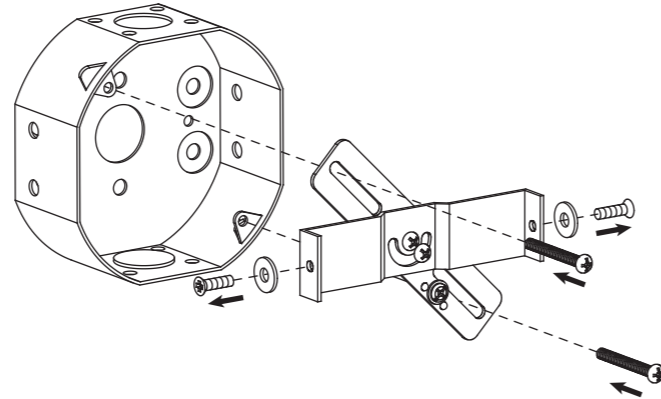

STEP 2

Make the electrical connection from the junction box (not included) to the **fixture**. Connect the ground wire to the **mounting unit** using the preinstalled green ground screw. Next, connect the live wire, neutral wire and ground wires with the supplied **wire nuts**. Secure with electrical tape.

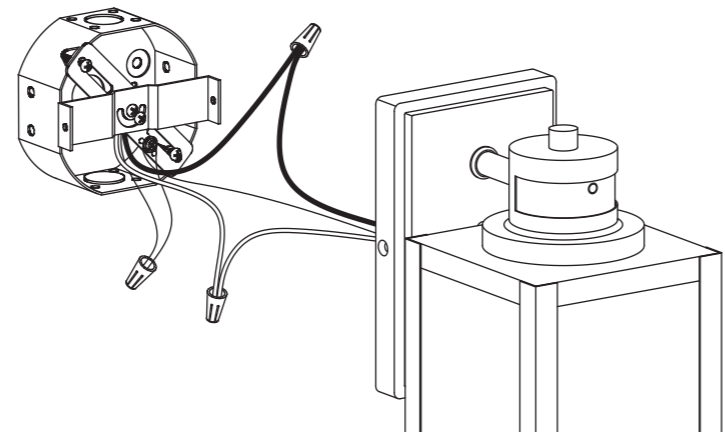
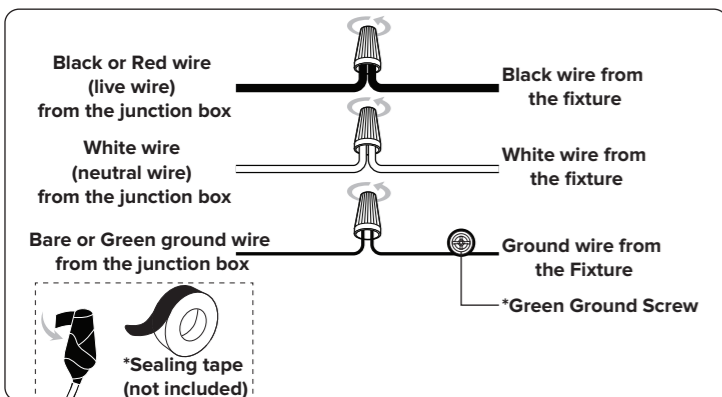

STEP 3

Attach the **fixture** to the **mounting unit** through **screw holes** as shown, and secure it with **rubber rings** and **screws**.

NOTICE: Please use caulk in the back plate and wall mounting surface to prevent water from entering.

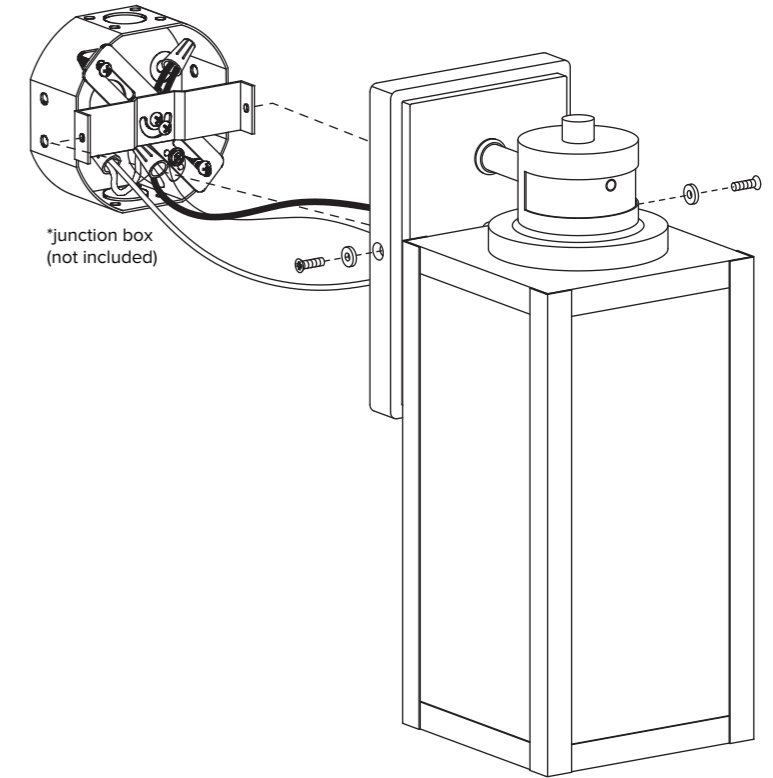

STEP 4

Install bulb (not included)

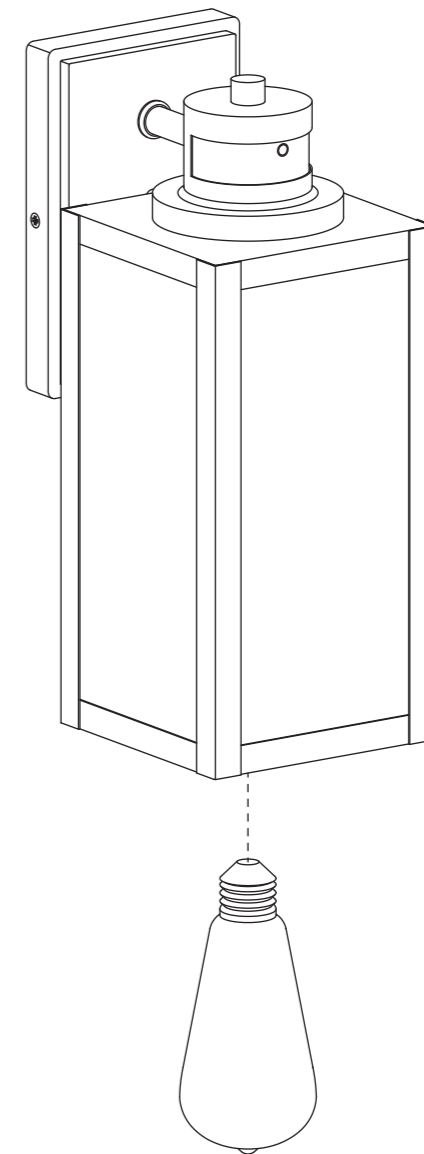

BASIC FUNCTION

● BOOT PREHEATING

- ◆ Day or night, there will be 15±5 seconds of warm-up time after the product is powered on for the first time, at this time, the bulb will be on at 100% brightness. It will automatically enter TEST MODE after it is preheated.

● TEST MODE

- ◆ Day or night, the brightness of the bulb will be reduced to 40% after the startup is preheated, when human activity is detected, brightness will be increased to 100%, until 5±3 seconds after the human body left the detection range, the brightness level again dropped to 40%

* **Note:** This state is two-step mode, if it is single-step mode, the bulb will be off after the startup is preheated. After human activity is detected, the bulb will light up to 100% brightness, and it will be off again 5±3 seconds after the human body leaves the detection range.

● AUTO MODE

- ◆ The product will automatically enter AUTO MODE and the LED indicator will blink for 4 times when the time reaches 120±20 seconds after startup preheating.
- ◆ In AUTO MODE, the light is not on during the day. When the ambient light brightness reaches the starting condition (20~90LUX) at night, the bulb will be steady on at 40% brightness (at this time, it is in two-step mode, and the bulb will not be on in single-step mode). When human activity is detected, the bulb will be on at 100% brightness. Until 120±20 seconds after the human body leaves the detection range, it will return to 40% brightness to be steady on (That is in two-step mode, in single-step mode, the bulb will be turned off). When the ambient light reaches the off condition (MAX. 600LUX) and 60±10 seconds later, the bulb will be automatically extinguished.
- ◆ Turn off the power switch in TEST MODE and turn it on within 3 seconds to enter AUTO MODE directly.

● MANUAL OVERRIDE 8H MODE

- ◆ It can only be accessed in AUTO MODE. When the ambient light reaches the starting condition (20~90LUX) at night, turn off the power switch and turn it on within 3 seconds, enter MANUAL OVERRIDE 8H MODE, and the LED indicator will blink for 6 times quickly, at this time, the bulb will keep on bright for 8±1H. When the ambient light reaches the off condition (MAX. 600LUX) after 8±1H and 60±10 seconds, the bulb will automatically turn off and return to AUTO MODE.
- ◆ In MANUAL OVERRIDE 8H MODE, reset to AUTO MODE after turning off the power switch and turning it on within 3 seconds.

● SINGLE/DOUBLE STEP MODE DESCRIPTION AND SWITCHING

- ◆ Single-step mode: When human activity is detected, the bulb will turn on 100% brightness, after a certain period of time, the bulb will automatically turn off. When the next human activity is detected, the bulb will turn on 100% brightness again.
- ◆ Two-step mode: When human activity is detected, the light bulb will turn on 100% brightness, until the human body out of the detection range for a certain period of time, the light bulb will drop to 40% brightness, and then turn on 100% brightness again when the next human activity is detected.
- ◆ Single or double - step mode can be switched through the key switch in front of the sensor. Every time a key switch is pressed, the product returns to TEST MODE, day or night, in any mode.

● LED INDICATING LAMP

- ◆ When entering single-step mode, the LED indicator flashes once.
- ◆ When entering the two-step mode, the LED indicator flashes twice.
- ◆ When human activity is detected, the LED indicator flashes once.
- ◆ When entering AUTO MODE, the LED indicator blinks 4 times.
- ◆ When entering MANUAL OVERRIDE 8H MODE, the LED indicator quickly blinks 6 times.
- ◆ When exiting MANUAL OVERRIDE 8H MODE, the LED indicator quickly blinks 3 times.

● CIRCUIT BREAKER RESET

- ◆ After the power is off for more than 5 seconds, the product will re-enter the preheating state after the power is turned on again.
- ◆ The product has the function of memory. After the power failure reset, the power will keep the single or double step mode before the power failure.

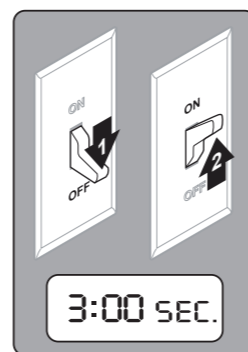
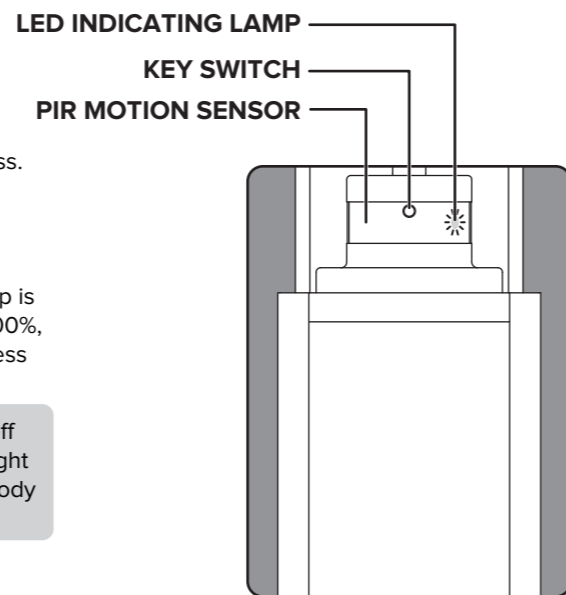

ELECTRICAL PARAMETER

- Rated voltage: 120VAC/60Hz; The bulb should be installed at less than the rated power of the sensor; LED lamp 45W; Incandescent lamp 60W.

DETECTION RANGE (at 25°C)

- When the ambient temperature is 25°C and the sensor is suspended 1.8m~2.2m above the ground, the sensor's detection Angle is 220° and the detection distance is MAX. 32.8FT(10m).

SELECTING A LOCATION

- When selecting a location, mounting the fixture too high or in front of a sloped surface, such as an uphill walkway or driveway, may affect the motion sensor's effectiveness.
- When selecting a location, be aware of the motion sensor is more sensitive to movement across its coverage area and less sensitive to movement toward or away from the motion sensor.
- Select locations away from heat sources, such as heating vents, air conditioners, and heated swimming pools.
- Select locations away from nighttime light sources, such as street lamps or other light fixtures. They may shine light onto the fixture's sensor. This light might cause the circuit to "think" that it is daytime.
- Be aware that shade from a porch or an eave may not allow onto the photocell sensor and may cause the circuit to "think" that it is nighttime, and subsequently cause the light to come on during the daytime.
- The detection range of the sensor shall not be blocked by the screen, furniture, large bonsai or other isolation objects.
- The input end of the sensor is not suitable for installing dimmers, only suitable for directly connecting to the standard input voltage
- Sensor away from electromagnetic wave products, such as WIFI router /WIFI camera, away from more than 2 meters to prevent electromagnetic wave interference.

ADDITIONAL NOTE

- Operating temperature range: -30°C~50°C

TROUBLESHOOTING

PROBLEM	POSSIBLE CAUSE	CORRECTIVE ACTION
Bulb won't light.	<ol style="list-style-type: none"> 1. Wall switch or circuit breaker is off. 2. Light bulb may be dead. 3. Light bulb is loose. 4. Incorrect or loose wire connections. 5. Power is off. 	<ol style="list-style-type: none"> 1. Turn on switch or circuit breaker. 2. Test the light bulb in a known working light fixture, replace bulb as needed. 3. Tighten light bulb in socket. 4. Check wire connections. 5. Make sure power supply is on.
The light does not turn on when there is motion.	<ol style="list-style-type: none"> 1. Too much sunlight is shining onto sensor in the early evening. 2. Too much light is shining onto sensor due to another light source, such as a street lamp or other light fixture. 3. Moving persons or vehicles are below the view of the motion sensor because motion sensor is mounted too high. 	<ol style="list-style-type: none"> 1. Relocate fixture away from a western facing wall. 2. a- Eliminate or turn off other light source. b- Block other light source from shining onto photocell sensor. c- Relocate fixture. 3. Relocate fixture to a lower position or to a different location.
The light comes on for no apparent reason.	<ol style="list-style-type: none"> 1. Street or sidewalk traffic is triggering the motion sensor. 2. False triggering caused by a heat source, such as a heater or dryer vent, or heated swimming pool. 	<ol style="list-style-type: none"> 1. Relocate fixture to a different location. 2. a- Eliminate heat source. c- Relocate fixture.
The light comes on during the daytime or too early in the evening.	The fixture may be installed in a shaded area, such as under a porch or eave, preventing daylight from shining onto the photocell sensor.	Relocate fixture
The light comes on too late in the evening.	Too much sunlight is shining onto the sensor in the early evening.	Relocate fixture away from a western facing wall.

