



Easy Open Push Button



Built-in Sensor



Pre-Set :

- Detection Area : 100%
- Hold Time : 5s
- Stand-by Period : 0s
- Stand-by Dim Level : 10%
- Daylight Sensor : Disable

Option:



Technical Specifications			
Model No.:	ECS20-2FT347-3CCT-S	ECS40-4FT347-3CCT-S	ECS80-8FT347-3CCT-S
Size	2 ft	4 ft	8 ft
Watt Selectable	11W/14W/17W/20W ADJ	25W/30W/35W/40W ADJ	50W/60W/70W/80W ADJ
Voltage	120-347V		
Dimming	0-10V		
Sensor	Microwave Motion Sensor		
CCT Selectable	3000K/4000K/5000K Adjustable		
Lumens	1430LM-2600LM	3250LM-5200LM	6500LM-10400LM
Dimensions	24" x 2.95 x 3.27"	48" x 2.95 x 3.27"	96" x 2.95 x 3.27"

Features

- 0-10 V Dimming
- Safe for food service applications
- For single or continuous row mounting
- 5 years warranty

Electrical

- Input voltage: 120-347VAC
- Power factor: >0.9
- THD: <20%

Performance

- Rated lifetime L70 : 50/000 Hours
- CRI > 80
- Optional : Sensor & Emergency

Installation

Surface Mount Installation

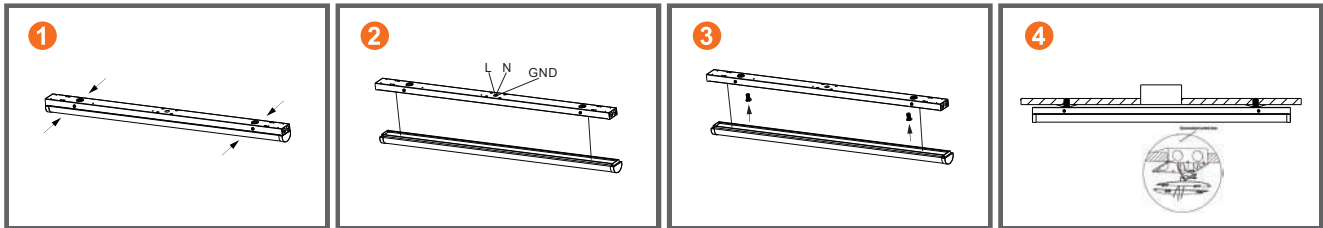

Chain Hang Installation

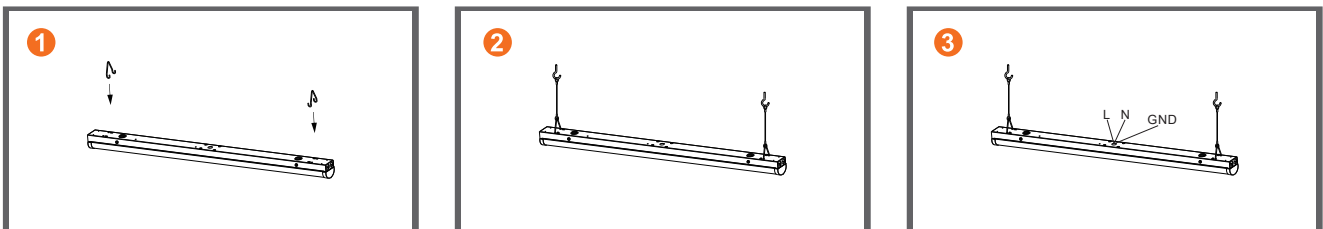

Linkable Installation

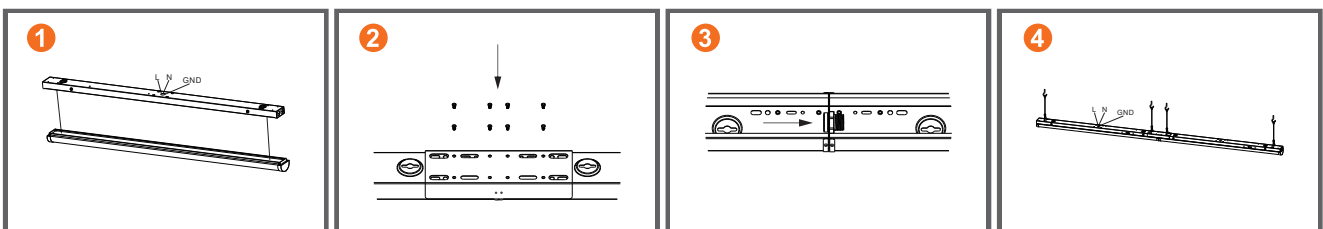

Lumen Output

	2FT				4FT				8FT			
	11W	14W	17W	20W	25W	30W	35W	40W	50W	60W	70W	80W
3000K	1430lm	1820lm	2210lm	2600lm	3250lm	3900lm	4550lm	5200lm	6500lm	7800lm	9100lm	10400lm
4000K	1540lm	1960lm	2380lm	2800lm	3500lm	4200lm	4900lm	5600lm	7000lm	8400lm	9800lm	11200lm
5000K	1485lm	1890lm	2295lm	2700lm	3375lm	4050lm	4725lm	5400lm	6750lm	8100lm	9450lm	10800lm

Dimensions

Models	L	W	H
ECS20-2FT347-3CCT-S	24"	2.95"	3.27"
ECS40-4FT347-3CCT-S	48"	2.95"	3.27"
ECS80-8FT347-3CCT-S	96"	2.95"	3.27"



Image Show

