

Project : \_\_\_\_\_  
 Type : \_\_\_\_\_  
 Drawn by : \_\_\_\_\_  
 Catalogue No. : \_\_\_\_\_  
 Date : \_\_\_\_\_



## Specifications

Model No.		<input type="checkbox"/> VO-TRKW20-120-HL-5WAY/WH	<input type="checkbox"/> VO-TRKW20-120-HL-5WAY/BK
General	Watts	20/15/10W	20/15/10W
	Halogen Equivalent	50-250W	50-250W
	Lumen	900-1800lm	900-1800lm
	Base	halo base	halo base
	CCT	27/30/35/40/50K	27/30/35/40/50K
	Volts	AC120V	AC120V
	CRI	>90	>90
	Beam Angle	36°	36°
	Hours Rated	50000 hours	50000 hours
Electrical	Operating Frequency	60Hz	60Hz
	Power Factor	>0.9	>0.9
	Operating Position	Damp Location	Damp Location
	Surge Protection	4KV	4KV
Operating Temperature	-20°C~45°C (-4°F~113°F)	-20°C~45°C (-4°F~113°F)	
Physical	Lens Material	PC	PC
	Housing Color	White	Black
Additional Information	Additional Info	CCT+Power adjustable	CCT+Power adjustable
	Rated For Enclosed Fixture	NO	NO
	Warranty	5 Years	5 Years
Compliance	Safety Listing	ETL Listed	ETL Listed
	Location Rating	Damp	Damp
	Energy Star	No	No
	DLC Approved	Premium 5.1	Premium 5.1
DLC ID	S-JGLFPT	S-JGLFPT	

### Features & Specifications

#### Construction

- Cold-forged aluminum heat sinks, which are optimal for heat control to ensure quality
- Can pivot +/-90° vertically and rotate 350° horizontally
- CCT and power selector switch in housing
- With halo base
- Daisy connection with very convenient replacement in 1 minute

#### Mounting

- Available with suspending installation and surface-mounted installation

#### Performance Data

- 20/15/10W, 2700K/3000/3500/4000/5000K selectable
- 90+ CRI
- Electrical ratings: AC120V
- High-Efficacy with precise Center Beam Candle Power
- Triac Dimming
- Cold-forged aluminum heat sinks, which are optimal for heat control to ensure quality
- Operating temperature: -20°C~45°C (-4°F~113°F)

#### Compliances

- ETL certified for damp locations
- IP20
- DLC Premium

#### Application

- Stores, Showrooms, Restaurants, and various Commercial & Residential spaces

### Dimensions & Weights

Model	VO-TRKW20-120-HL-5WAY
Diameter in.(cm)	2.44in(6.2cm)
Height in. (cm)	6.73in(17cm) 9.69in(24.6cm)
Net weight lbs (kg)	1.3lb(0.59kg)

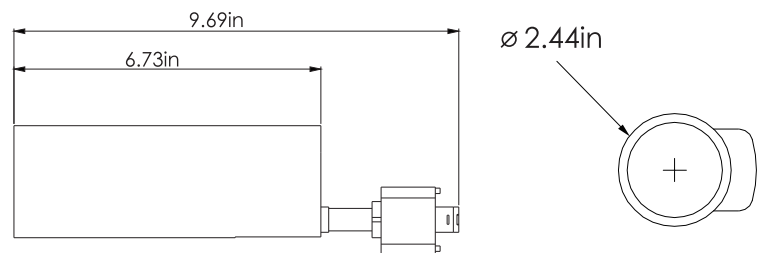

VO-TRKW20-120-HL-5WAY

### Product Details

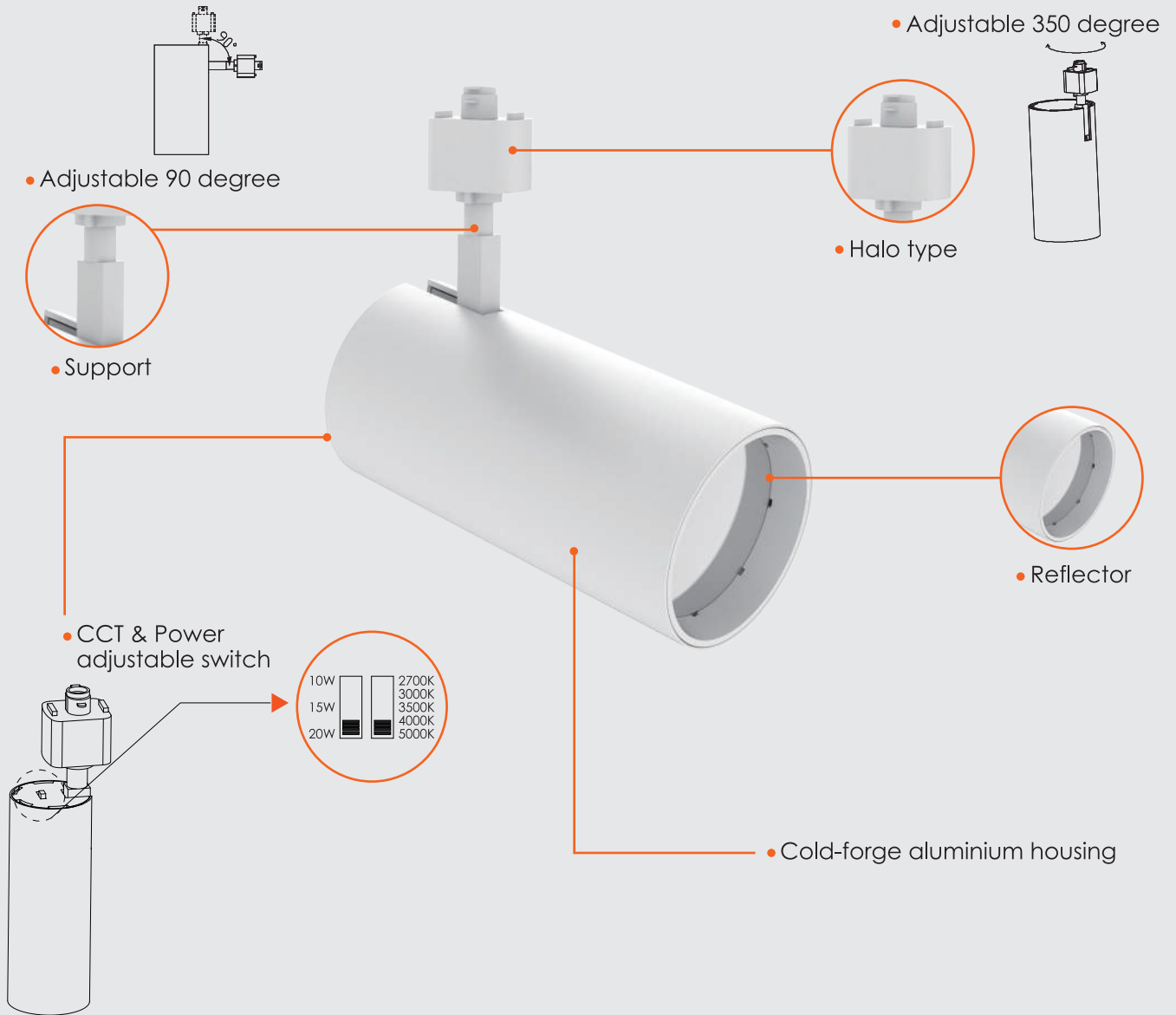

### Installation

3 track lights can be installed in 1 ft of the tracks with 1 adapter, and 12 track lights can be installed in 4 ft of the tracks with 1 adapter

### Accessories(Order Separately)

Order Code	Accessory Name	Compatible with
PRO-0302A/WH PRO-0302A/BK	2FT , Halo-Style , 3-Wire Track White / Black	Halo Track
PRO-0304A/WH PRO-0304A/BK	4FT , Halo-Style , 3-Wire Track White / Black	Halo Track
PRO-0308A/WH PRO-0308A/BK	8FT , Halo-Style , 3-Wire Track White / Black	Halo Track
PRO-0331/WH PRO-0331/BK	Conduit End Feed White / Black	Halo Track
PRO-0332/WH PRO-0332/BK	End Cap White /Black	Halo Track
PRO-0333/WH PRO-0333/BK	Mini Connector White / Black	Halo Track
PRO-0335/WH PRO-0335/BK	"L" Connector White / Black	Halo Track
PRO-0336/WH PRO-0336/BK	"T" Connector White / Black	Halo Track
PRO-0337/WH PRO-0337/BK	"x" Connector White / Black	Halo Track
PRO-0339/WH PRO-0339/BK	Flexible Connector (flexible wire in middle part) White/Black	Halo Track
PRO-0344/WH PRO-0344/BK	Live End Conduit Connector	Halo Track
PRO-0341/WH PRO-0341/BK	Floating Canopy Feed White / Black	Halo Track



End Cap



Halo-Style 3-Wire Track-2FT/4FT/8FT



"T" Connector



Flexible Connector



Conduit End Feed



"x" Connector to



Mini Connector



Live End Conduit Connector



"L" Connector



Floating Canopy Feed

### Lumen Details

Model	Power	2700K		3000K		3500K		4000K		5000K	
		Luminous Flux	Input Voltage	Luminous Flux	Input Voltage	Luminous Flux	Input Voltage	Luminous Flux	Input Voltage	Luminous Flux	Input Voltage
VO-TRKW20-120-HL- D-5WAY/W	10/15/20W	1425	AC120V	1500.2	AC120V	1560.8	AC120V	1691.8	AC120V	1576.6	AC120V
VO-TRKW20-120-HL- D-5WAY/B	10/15/20W	1425	AC120V	1500.2	AC120V	1560.8	AC120V	1691.8	AC120V	1576.6	AC120V

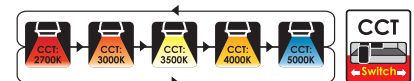

Data is based upon tests performed in a controlled environment. Actual performance can vary depending on operating conditions. All products are subject to change or may be discontinued any time without notice. Please contact your Votatec customer service representative to confirm inventory levels at time of order

