

Project : _____
 Type : _____
 Drawn by : _____
 Catalogue No. : _____
 Date : _____



Specifications

Model No.		□ PV-8FT-42WABOE-50K
General	Size	8'
	Watts	42W
	Target Lamp	96W
	Lumen	5500LM
	Base	Fa8 or R17D
	CCT	5000K
	Volts	AC120-347V
	CRI	>83
	Beam Angle	200°
	Hours Rated	50,000 hours
	Max Compartment Size	Length: 93.54in. Width: 1in
	Ballasting Requirements	Ballast Compatible and Ballast Bypass
Electrical	Operating Frequency	50-60Hz
	Power Factor	>0.9
	Wiring	Double-ended 2 pins connected
	Surge Protection	Ring Wave Surge 2.5KV
	Operating Temperature	-20°C(-4°F) TO 45°C(113°F)
Physical	Housing Material	Glass with PET Coating
	Housing Color	Milky
	Net Weight (Kg)	0.43
Additional Information	Additional Info	Multi-Voltage
	Warranty	5 years
Compliance	Safety Listing	cULus
	Location Rating	Dry
	DLC Approved	Under certification
	DLC ID	TBD

Features & Specifications

Construction	<ul style="list-style-type: none"> • Type A+B, work with ballast or AC120-347V direct power input, provides easy installation • High Compatibility: Work with 130+electronic ballasts, including emergency&dimming ballasts • Double-ended 2 pins connected • 2 in 1: Fa8 and R17d pins end cap can be replaced with each other • Shatterproof design, lower the breakage rate also safe for shipping
Mounting	<ul style="list-style-type: none"> • Clip included for lock the tube in the middle without bending issue
Performance Data	<ul style="list-style-type: none"> • 83+ CRI • Electrical ratings:120-347V • Estimated life of over 100 000hours to L70 • 0-10V dimming • Operating temperature:-20°C(-4°F) to 45°C(113°F)
Compliances	<ul style="list-style-type: none"> • cULus certified • Meets NSF requirements (Splash Zone and Non Food Zone) • DLC 5.1 Standard (Under Certification)

Dimensions & Weights

Model No.	PV-8FT-42WABOE-50K
Length A in.(mm)	93.54" (2375.8)
Length B in.(mm)	92.94" (2360.6)
Length C in.(mm)	92.15"(2340.6)
Length D in.(mm)	1" (25.4)
Net weight kg.(lbs)	0.43" (0.95)

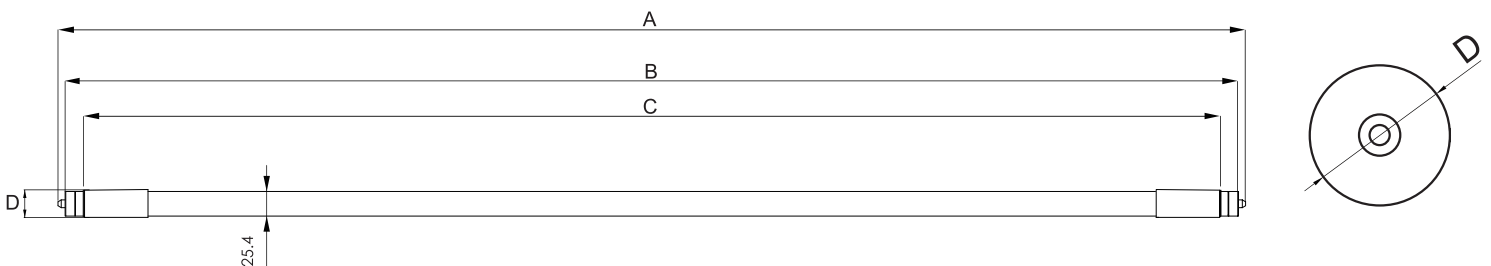

Product Details



- Fa8 end cap and R17d end cap convertible, meets different requirement



- Anti-Rotation Clip in the middle, without rotation and bending issue

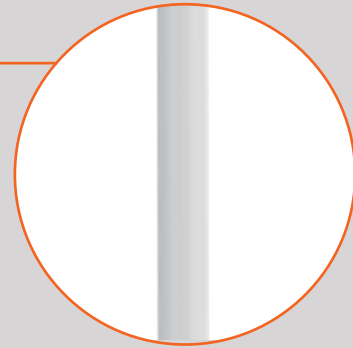

- PET coating film, shatterproof design for transportation protection

Accessories

Order Code	Compatible with	Order Option
FA8	PV-8FT-42WABOE-50K	Included
R17D	PV-8FT-42WABOE-50K	Order seperately
Anti-Rotation Clip	PV-8FT-42WABOE-50K	Included



FA8



R17D



Anti-Rotation Clip

Wiring Diagram

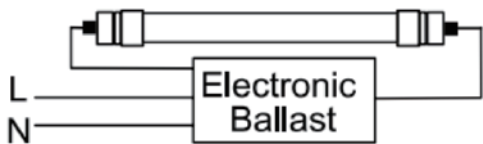

TYPE A (Ballast compatible)

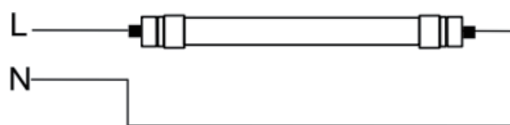

TYPE B (AC directly, double end ballast bypass)

Voltage Input: AC120-347V 50/60Hz

Direct AC wiring diagram with 0-10V dimming system

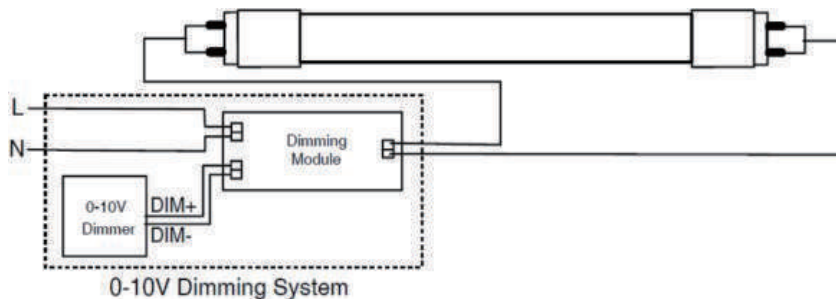

Ballast Compatible

1. Our tubes can be compatible with the ballasts listed below, if you intend to install ballast compatible tube with ballasts not be listed below, risk of damage or losses may occur. We disclaim liability for any damage or losses by not following the instructions in this document.

2. We are testing more and more ballasts and will update this list all the time. If you do not see your ballast on the list, please contact us.

Y refer to Compatible N refer to Not Compatible N/A refer to Not Applicable

AC 37V Ballast Compatible List

No	Ballast Brand	Model No.	Start Type	Compatible (Y/N/N/A)			
				1 LAMP		2 LAMPS	
				120VAC	277VAC	120VAC	277VAC
1	GE	GE260IS-MV-N-DI	Instant Start	Y	Y	Y	Y
2	GE	GE260ISMV-N-DIY	Instant Start	Y	Y	Y	Y
3	GE	GE259MAX-G-N-DIYB	Instant Start	Y	Y	Y	Y
4	GE	GE259MAX-L/ULTRA	Instant Start	Y	Y	Y	Y
5	ACT	ACT2P59ISUNV	Instant Start	Y	Y	Y	Y
6	Halco	EP259IS/MV	Instant Start	Y	Y	Y	Y
7	Triad	B259IUNVHP-A	Instant Start	Y	Y	Y	Y
8	OSRAM	QTP 2X96T12/UNV IS	Instant Start	Y	Y	Y	Y
9	OSRAM	QTP 2X59T8/UNV ISN-SC	Instant Start	Y	Y	Y	Y
10	OSRAM	QHE 2X59T8/UNV ISN-SC	Instant Start	Y	Y	Y	Y
11	HI HOWARD INDUSTRIES	EP2/59IS/MV/MC/H	Instant Start	Y	Y	Y	Y
12	PHILIPS ADVANCE	ICN-2P60-N	Instant Start	Y	Y	Y	Y
13	PHILIPS ADVANCE	IOP-2P59-N	Instant Start	N	N	Y	Y
14	ADVANCE	VEL-2P59-S-RH-TP	Instant Start	N/A	Y	N/A	Y



Data is based upon tests performed in a controlled environment. Actual performance can vary depending on operating conditions. All products are subject to change or may be discontinued any time without notice. Please contact your Votatec customer service representative to confirm inventory levels at time of order

