

# Dimmable LED T-Bar Frame Light

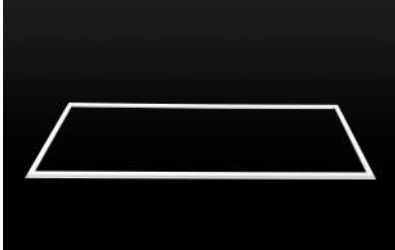

### Specifications

Check product label for specific electrical specifications related to installation. Improper installation will void warranty.

### Wiring Diagram

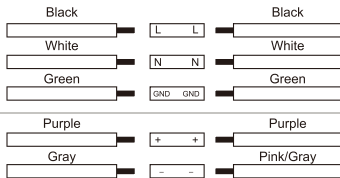

### Selectable CCT and Wattage Switches

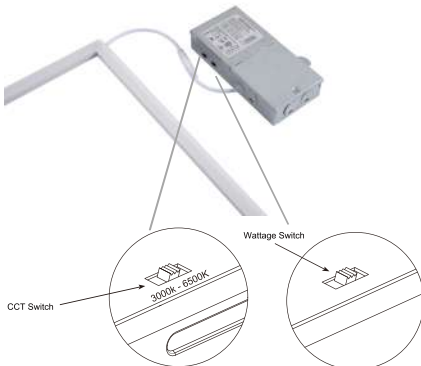

### Safety and Notes

- To reduce the risk of accident, and injury or property damage from fire, electric shock, falling parts, cuts/abrasions, and other hazards read all warnings and instructions included with and on the fixture box and all fixture labels.
- Before installing, servicing, or performing routine maintenance upon this equipment, follow these general precautions
- Commercial installation, service and maintenance of luminaires should be performed by a qualified licensed electrician.
- For the installation: If you are unsure about the installation or maintenance of the luminaires, consult a qualified, licensed electrician and check your local electrical code.
- To prevent wiring damage or abrasion, do not expose wiring to edges of sheet metal or other sharp objects.
- Do not make or alter any open holes in an enclosure of wiring or electrical components during kit installation.
- **WARNING:** Turn off electrical power at fuse or circuit breaker box before wiring fixture to the power supply.
- Turn off the power when you perform any maintenance.
- Verify that supply voltage is correct by comparing it with the luminaire label information.
- All wiring connections should be capped with UL approved wire connectors.
- **CAUTION:** Avoid direct eye exposure to the light source while it is on.
- Account for small parts and destroy packing material, as these may be hazardous to children.
- **NOTICE:** Risk of burn. Disconnect power and allow fixture to cool before changing bulb or handling fixture.
- Green ground screw provided in proper location. Do not relocate
- Minimum 90° supply conductors.
- **NOTICE:** Specifications and dimensions subject to change without notice.
- **NOTICE:** Suitable for Dry or Damp location, Type IC.
- Failure to properly support the fixture may result in damage or injury, for which the manufacturer does not assume responsibility. A safety cable is not included, but it is recommended that one be connected to grid clip during installation.

### Dimmable LED T-Bar Frame Light

#### Drop Ceiling Installation

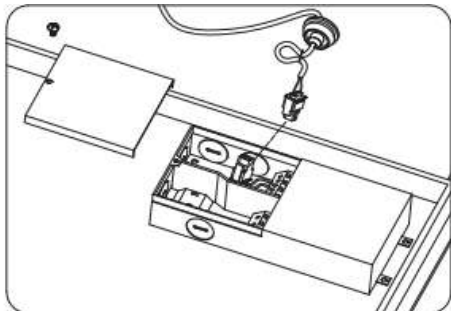

a) Screw off the cover of the driver  
knock off one of the knock-out on the driver

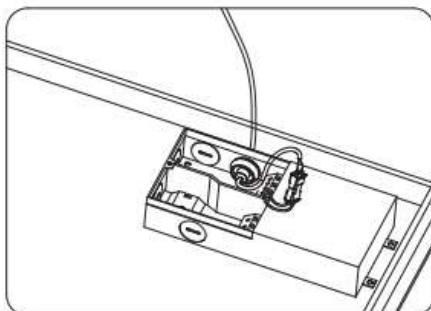

b) Install the grommet in the knock-out, and connect  
the connector together

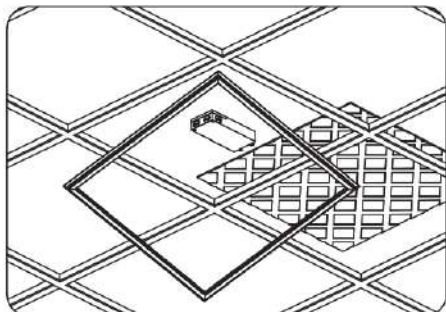

c) Remove the plasterboard and install the frame  
light in the T-bar.

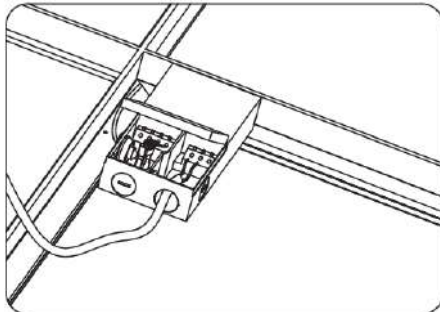

d) Take off knock-out one the other side, connect all  
wires with the AC input properly according to the  
labels on wires.

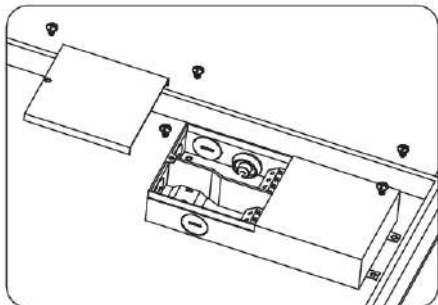

e) Install the driver to the a rigid location. Driver  
should not be mounted in or near a fan air outlet or  
other HVAC system components.

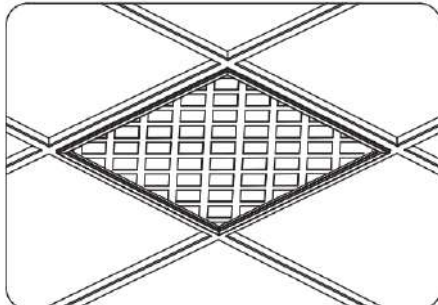

f) Move the plasterboard back over the frame  
fixture make sure it sits well above the frame light.  
You may have to make a small notch in ceiling  
panel to accommodate the lead wire.