

R - Surface mounting with open PC clips(R25-IA01)

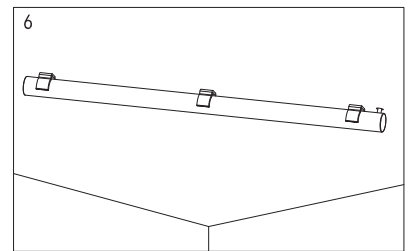

R - Surface mounting with PC profile

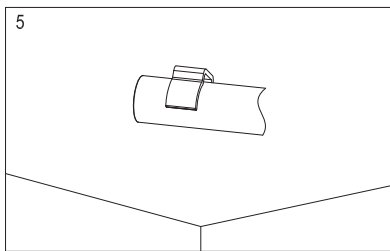
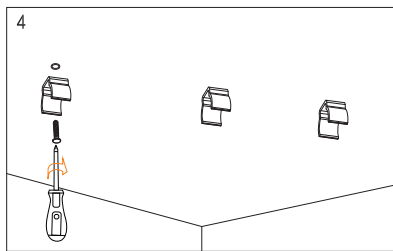
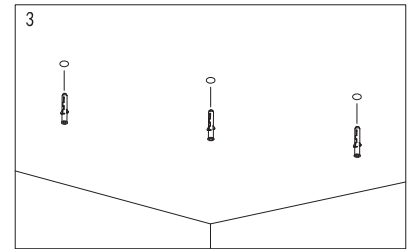
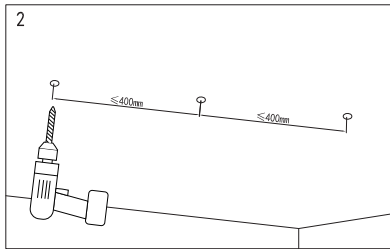
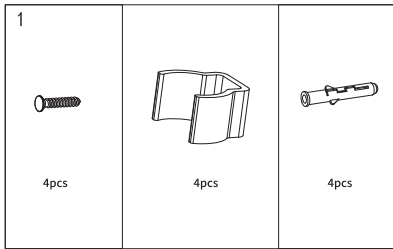
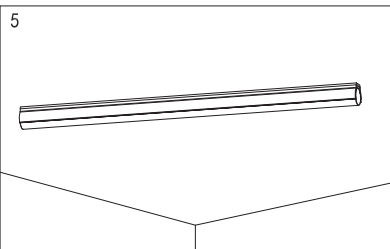
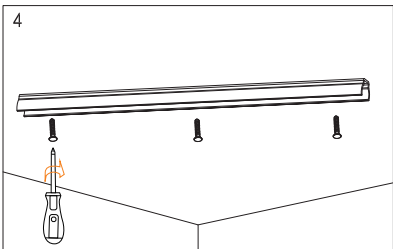
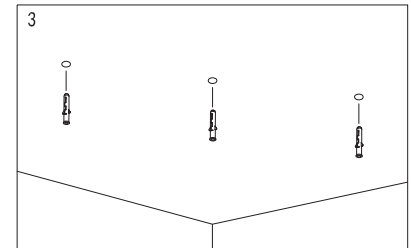
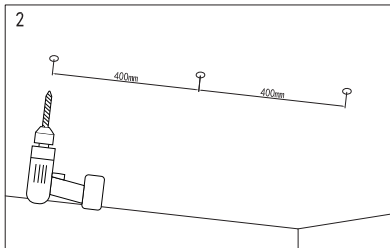
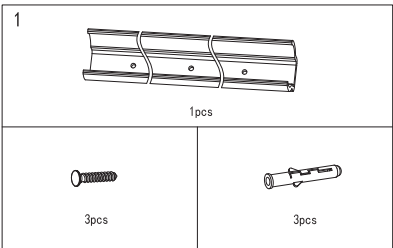

R - "—" type hanging mounting with open PC clips

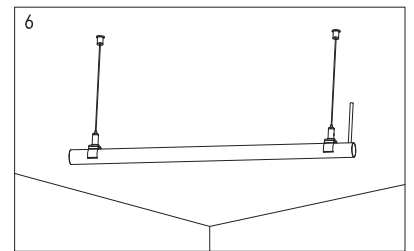
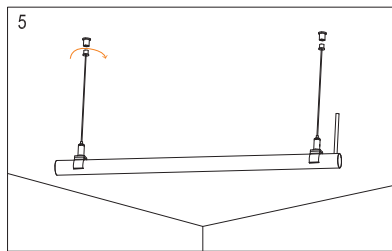
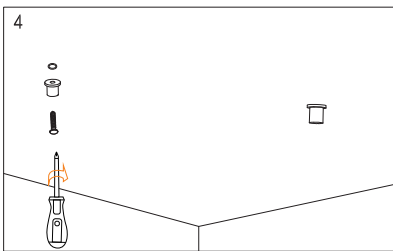
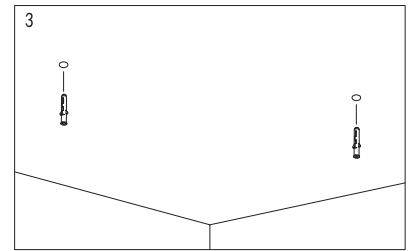
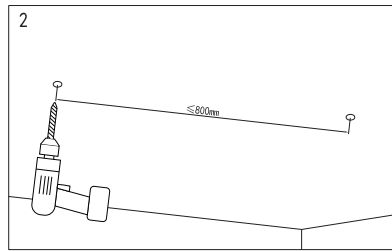
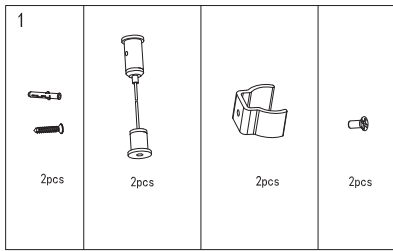

5 - "—" type hanging mounting with PC profile

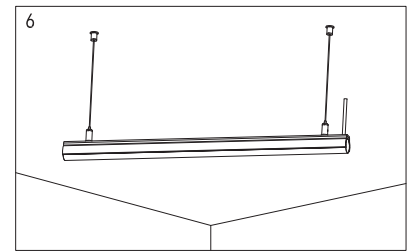
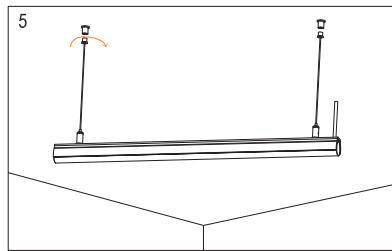
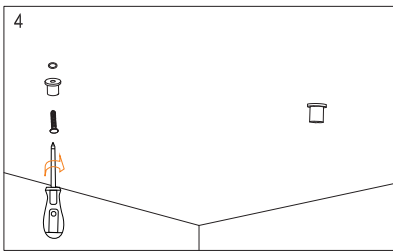
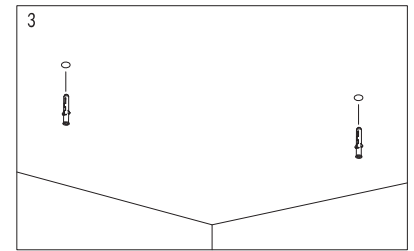
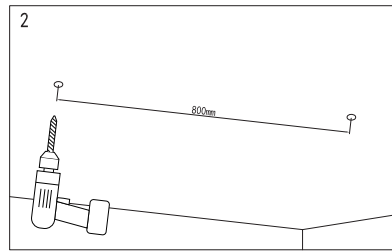
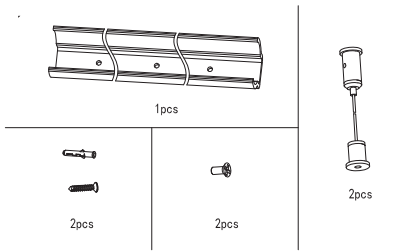

Installation/Use Precautions

- ◆ The unopened products and the unused products after unpacking, should be sealed in packaging bags to avoid long-term exposure.
- ◆ Please use AC 110V voltage. Other types of power supply may damage the product or cause other safety risks.
- ◆ In practical application, the power supply should be retained with a 20% allowance (it is recommended to use only 80% power of the power supply) to ensure the stability of the power supply.
- ◆ Professional operators are recommended to wire and connect the power supply. It is strictly prohibited to connect the power supply with electricity in case of electric shock.
- ◆ Please confirm whether the voltage of the power supply is consistent with the voltage of the product before wiring.
- ◆ Please note the positive and negative sides of the power cord and connect them properly.
- ◆ When using multiple power supply, the situation of parallel connection of the positive pole of the power supply should be avoided. It will lead to instability of the power supply system and damage to the product after long-term operation.
- ◆ If the actual length of the application exceeds the specified length, it will lead to the phenomenon of heating and uneven brightness of the strip due to overload.
- ◆ During installation, please avoid twisting or irregular bending of the strip, and avoid any operation that will scratch the strip, otherwise it may cause irreparable damage to the product.
- ◆ In order to ensure the life and reliability of the strip, please ensure that the diameter of the bending should be greater than 50mm.
- ◆ For the sake of eye protection, please avoid looking directly at the illuminated surface for a long time.
- ◆ Non-professionals are strictly prohibited from installing, disassembling or repairing the strip.
- ◆ Do not use any acid or alkaline adhesive to fix the strip (including but not limited to glass glue, etc.)
- ◆ Different levels of waterproof, different use environment. IP65 is not suitable for immersion application.
- ◆ Due to structural differences, the final visual color of the strip will be slightly different for products of different sizes and specifications under the same color temperature value.
- ◆ Due to the difference in structure, the same color temperature value, different size/specification of the strip, their final visual color will be slightly different. Please make confirmation before use.
- ◆ It is forbidden to cut this product to avoid damage to the strip due to improper operation.
- ◆ Customers are not allowed to cut this product by themselves.

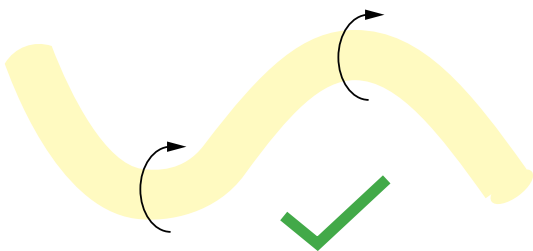

Bending diameter must be greater than 50mm

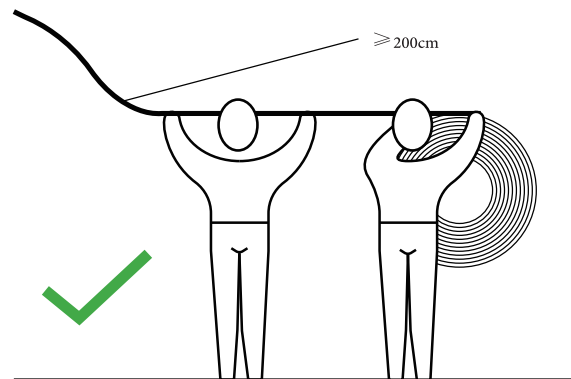

When the length of the strip is longer than 2 meters, have two people work together to install it.

Installation/Use Precautions

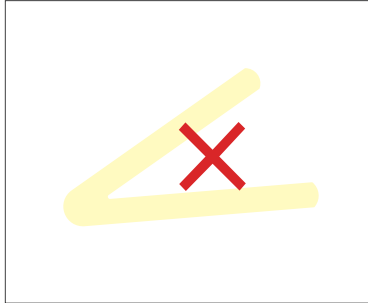

Small Angle bending is prohibited



Prohibit trample

Tests show that formaldehyde and benzene substances will make products yellowing. If the products are used in the indoor environment of new decoration, epoxy floor paint, wall paint, wallpaper adhesive, all kinds of decoration materials, or new furniture, are likely to release formaldehyde and benzene substances.

In order to avoid silicone material affected, it is suggested that the use of the environment after the completion of the new decoration, formaldehyde and benzene should be removed first, or it should be ventilated for a period of time before installing the strip.

1. Open the LED strip in roll
Find the cut logo with suitable length
(every 0.5m)



2. Cut the extra copper wire
incase short circle



3. Insert the copper pin into the
copper wire holes with the small
ends



4. After inserting the small ends,
insert the big end into the connector
(into the 2 small holes)



5. Light on to test, if it's not working,
try step 6th; If lights on, go to step 7th.



6. If it's not working, try another end
with this strip same as step 3rd.



7. Put some waterproof glue into the
connector, insert the strip and do
sealing, it's better use waterproof
heat shrink tube out of the connector
and ensure full covered.



8. Put some glue in the end cap and do
sealing as step 7th.



9. Lighting on again, done!
Cut the power before you do any
installation.

