



Innovation & Quality

www.votatec.ca

Fan Grille With LED Light

19 Watt LED light

5Way CCT Adjustable

(2700/3000/3500/4000/5000K)

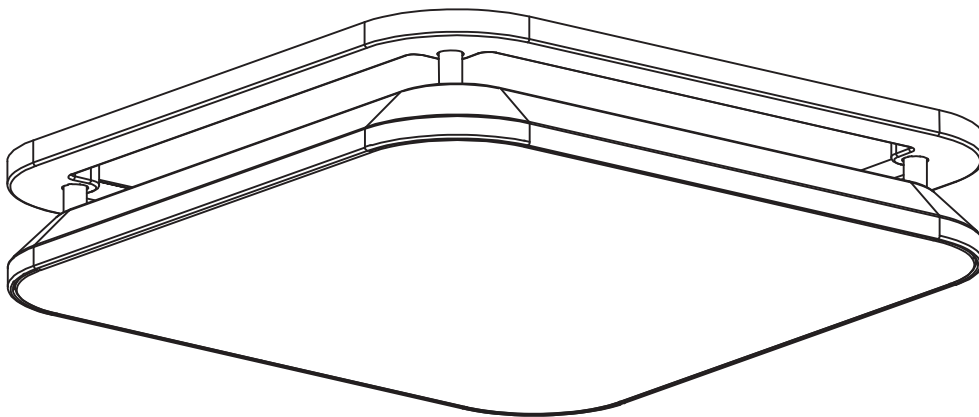

Compatible Model:

VO-FN4W18-AC-50,

VO-FN4W25-AC-80,

VO-FN4W26-AC-100

VO-FN4-LED-5WAY

SAFETY INFORMATION

READ AND SAVE THESE INSTRUCTIONS

1. **WARNING** — TO REDUCE THE RISK OF FIRE ELECTRIC SHOCK OR INJURY TO PERSONS, OBSERVE THE FOLLOWING:
 - a. Use this unit only in the manner intended by the manufacturer. If you have questions, contact the manufacturer.
 - b. Before servicing or cleaning unit, switch power off at service panel and lock the service disconnecting means to prevent power from being switched on accidentally. When the service disconnecting means cannot be locked, securely fasten a prominent warning device, such as a tag, to the service panel.
2. This ventilation fan is approved for use over a bathtub or shower when installed in a GFCI protected circuit. Do not use unapproved fans over a bathtub or shower that is not approved for that application.
3. Installation work must be carried out by a qualified person(s) in accordance with all local and safety codes including the rules for fire-rated construction.
4. Always vent fans to the exterior and in compliance with local codes.
5. Install ductwork in a straight line with minimal bends.
6. Use 120 V, 60 Hz for the electrical supply and properly ground the unit. Follow all local safety and electrical codes.
7. Do not use this fan with any solid-state control device; such as a dimmer switch. Solid-state controls may cause harmonic distortion, which can cause a motor humming noise.
8. When cutting or drilling into wall or ceiling, do not damage electrical wiring and other hidden utilities.
9. To reduce the risk of fire or electric shock, do not block air entry grill.
10. Sufficient air is needed for proper combustion and exhausting of gases through the flute (chimney) of fuel burning equipment to prevent back drafting.
11. Ducted fans must always be vented to the outdoors.
12. Mount with the lowest moving parts at least 2.5 meters above floor or grade level.
13. To reduce the risk of fire or electric shock, do not use this fan with any solid-state speed control device.

Follow the heating equipment manufacturer's guideline and safety standards such as those published by the National Fire Protection Association (NFPA), and the American Society for Heating, Refrigeration and Air Conditioning Engineers (ASHRAE), and the local code authorities.



WARNING Not suitable for use as a range hood.



NOTE Make sure duct work size is a minimum of the discharge. Do not reduce. Reducing the duct size can increase fan noise.



CAUTION For general ventilating use only. Do not use to exhaust hazardous or explosive materials and vapors.



IMPORTANT You may want to consult with a professional electrician regarding the wiring of your ventilation fan.



CAUTION Do not install in locations where the air temperature will exceed 104°F (40°C).



WARNING To reduce the risk of electric shock, please disconnect the electrical supply circuit to the fan before installing light kit.



IMPORTANT Exercise care to not damage existing wiring when cutting or drilling into walls or ceilings.



CAUTION This product must be properly grounded.

PRE-INSTALLATION

PLANNING FOR SUCCESSFUL INSTALLATION

The grille should be installed after the finished ceiling is in place.

If you are replacing an existing grill, ensure that the new grille will adequately cover the existing opening and its edges should overlap finished ceiling.

Not for use in cooking area - see installation instructions.

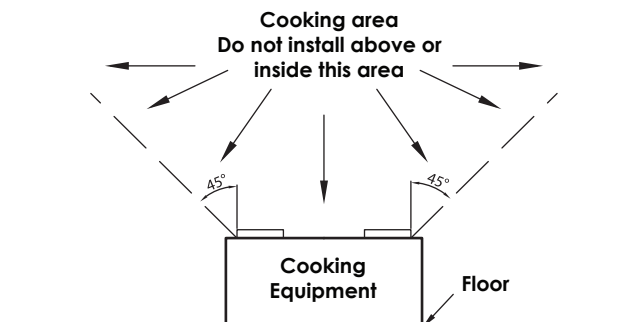

WIRING DIAGRAM

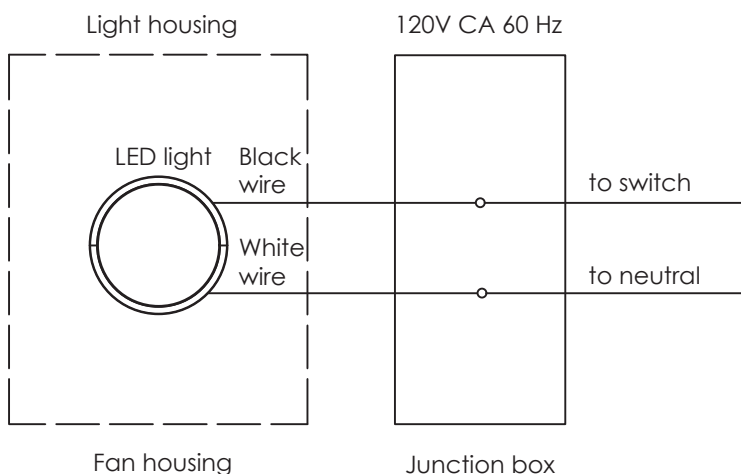

INSTALLATION

STEP 1

Remove the grill of the existing fan and confirm its housing model.

Note: Cut off all power supplies and ensure the fan is in a power-off state before removing the panel.

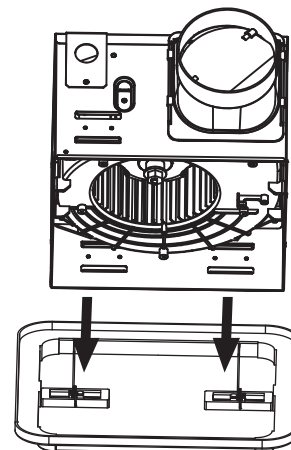

INSTALLATION

STEP 2

Select the CCT.

Select the proper CCT on the selector switch on the back of the grill according to your need.

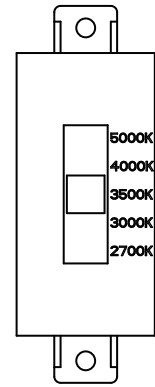

STEP 3

Plug the light in the power and install the grill.

Plug the LED light into the proper power units as the picture indicated. Attach grill by pinching the mounting springs and inserting them into the narrow rectangular slots in the fan housing. Test the light.

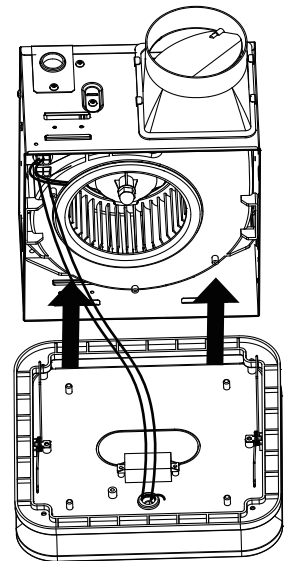

LIMITED 2-YEAR WARRANTY

If this product fails due to a defect in materials or workmanship at any time during the first 2 years of ownership the manufacturer will replace it free of charge, postage-paid at their option. This warranty does not cover products that have been abused, altered, damaged, misused, cut or worn. This warranty does not cover use in commercial applications. Use only manufacturer-supplied genuine warranty repair replacement parts to repair this fan. Use of non-genuine repair parts will void your warranty. The manufacturer DISCLAIMS all other implied or express warranties including all warranties of merchantability and/or fitness for a particular purpose. As some states do not allow exclusions or limitations on an implied warranty, the above exclusions and limitations may not apply. This warranty gives you specific legal rights, and you may have other rights that vary from state to state.

This warranty is limited to the replacement of defective parts only. Labor charges and/or damage incurred during installation, repair, replacement as well as incidental and consequential damages connected with the above are excluded. Any damage to this product as a result of neglect, misuse, accident, improper installation or use other than the purpose SHALL VOID THIS WARRANTY.