

Installation Instructions

TOOLS REQUIRED

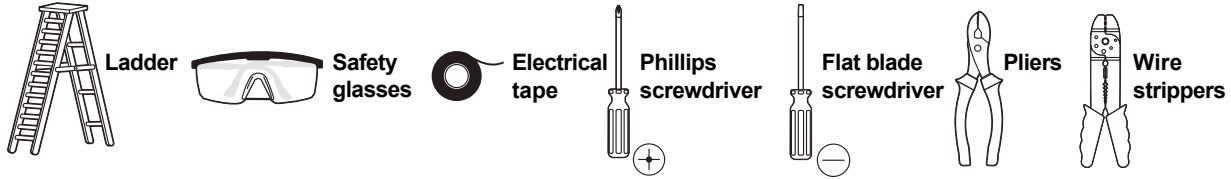

Disconnect the Electrical supply power at the services panel (fuse or circuit breaker box).

Failure to do so could result in serious injury.

Only qualified electricians should install this luminaire and the installation MUST be conform to the Canadian Electrical Code Part I, NEC and any local codes and ordinances.

Any change or modifications not expressly approved by the party responsible for compliance could void the authority to operate the equipment.

Makes sure you have the proper tools and materials to complete the installation before attempting to install the luminaire

INSTALLATION

1. Rotate and remove the lens from the luminaire (Fig. 1).

2. Make sure that the distance between two screws that will be installed on the junction box matches the built-in keyholes mounting slots of the back housing.
Screw the mounting screws into the junction box, leaving space to be able to insert the luminaire (Fig. 2).

3. Make wiring connections and push all wires inside the junction box (Fig. 3):
GROUND wire (green) of luminaire must be connected to the grounding conductor (green), the line wire (black) to the PHASE conductor (black) and the neutral wire (white) to the NEUTRAL conductor (white).

4. Install the luminaire housing on the junction box.

- Align the back housing built-in keyholes mounting slots with the mounting screws.
- Press the housing against the junction box and turn it in order to be retained by the mounting screws, as shown in Fig. 4.

5. Lock the housing to the junction box by tightening the mounting screws (Fig. 4).

6. Place the lens back on luminaire by inserting its hooks into the holes of the housing (Fig. 5) and rotating it (Fig. 6).

7. Apply power.

8. Select desired color temperature using the CCT switch located on the LED module.

NOTE: The motion sensor is set always ON and the hold time is 1/3/5 minutes (see range in Fig.7).

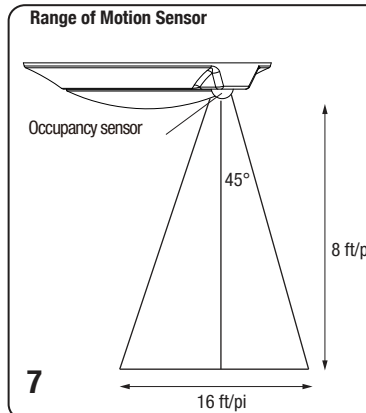
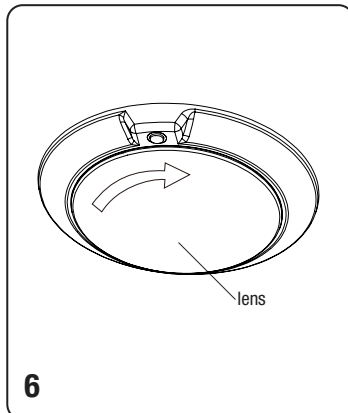
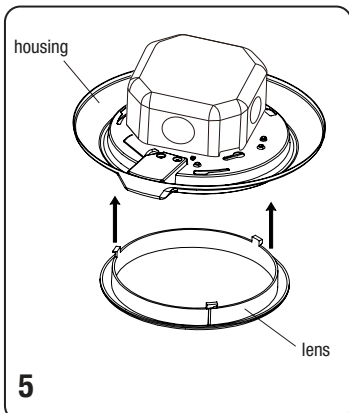
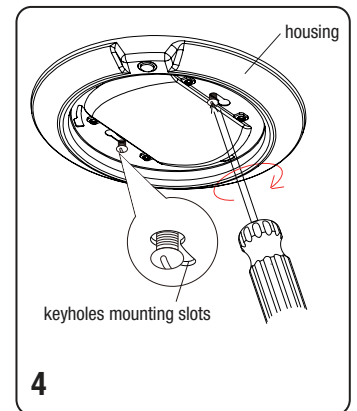
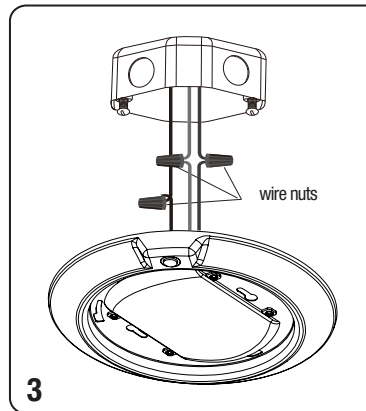
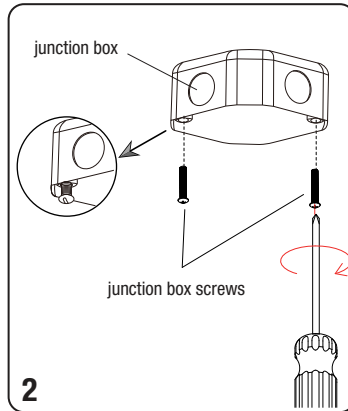
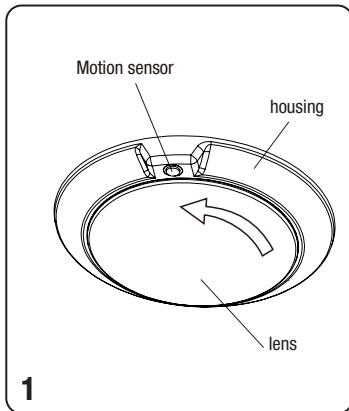

NOTE: IMAGES MAY NOT REFLECT YOUR EXACT MODEL AND ARE FOR REFERENCE PURPOSES ONLY.