

Project : _____
 Type : _____
 Drawn by : _____
 Catalogue No. : _____
 Date : _____



Live Wire



Timer Switch



Specifications

Model No.		□ HET06-J
General	Rated Voltage	120V,60Hz
	Rated Power	1800W
	Resistive	6.4A@125VAC
	Power Supply	Live Wire& Grounding& Load Wire
	Installation Method	In-wall
	Application	Indoor
	Relay Control Type	Latching Relay Control
	Contact Configuration	Single Pole
Load Range	Tungsten	800W@125VAC
	Electronic Ballast	800VA@125VAC
	Motor	1/4HP@125VAC
	Ballast(Fluorescent)	800VA@125VAC
Physical	MOL	4.11in
	WOW	1.73in
	MOH	1.76in
	Material	PC, Iron coated of Zinc
	Housing Color	White
	Weight(kg)	0.095
Operating Environment	Operating Temperature	0°C(32F) TO 40°C(104F)
Additional Information	Standard	UL917
	Warranty	2 years
Compliance	Safety Listing	cULus-Listed

Features & Specifications

Construction

- Single-pole latching relay control switch
- Wall-mounted, compatible with standard electrical boxes
- Standard decorator style wall plate included
- No neutral wire required

Features

- Operating voltage: 120VAC, 60Hz
- Automatic or manual operation
- Push the MAN button to switch On/Off at any time
- Set specific time intervals --options include 5 minutes, 30 minutes, 2 hours, and 4 hours
- It can be set as a clock
- Built-in memory holds settings indefinitely without power

Compliances

- cULus certified

Dimensions & Weights

Model	HET06-J
Length in.(cm)	4.11 (10.43)
Width in. (cm)	1.73 (4.39)
Height in. (cm)	1.76 (4.47)
Net weight (lbs)	0.095

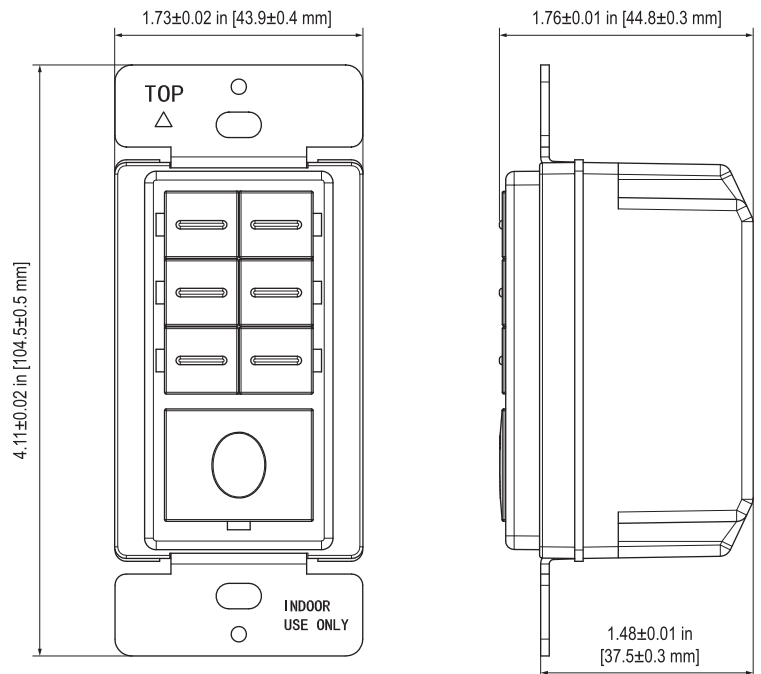

Product Details

- 6 times selection buttons with activation indicator lights



- Time can be customized

- LED indicator:
Mode 1: Light flashes twice to indicate setting success, then stays off.
Mode 2: LED stays On for locating

- ON/OFF button with hold on function

Typical Wiring Application

Turn off power at circuit breaker or fuse and test that power is off before wiring.

Install according to the wiring diagram above.

Carefully position all wires inside the wall-box, leaving enough space to insert the dimmer. Secure the dimmer with the provided mounting screws.

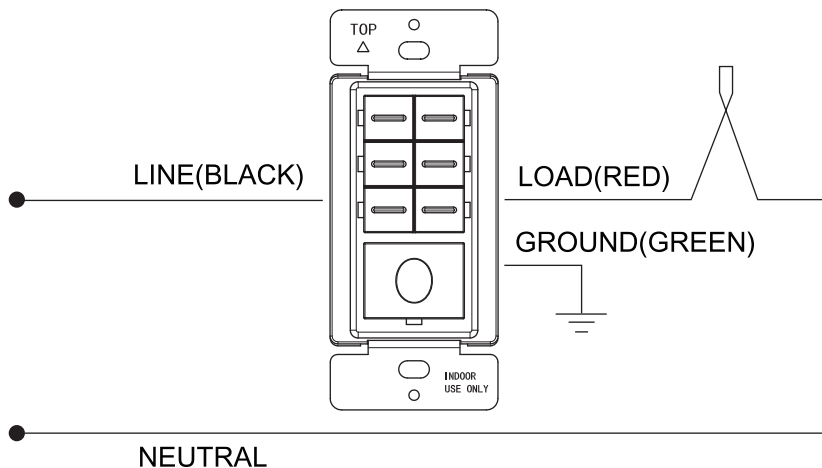

Live Wire



Timer Switch

